

# Floor Plans & Rates

## Residential Learning Community

The following installments are based on an individual liability lease and are listed per bedroom/per person. All accommodations are fully furnished.

For more information visit our website <https://www.tamtu.edu/housing>

### Utilities Included:

Electricity  
Internet  
Water  
Sewer  
Trash  
Cable Tv

### Scan to Apply



### 2 Bed - 1 Bath

Private Bedroom, Shared Bathroom

\$3,075 Per semester

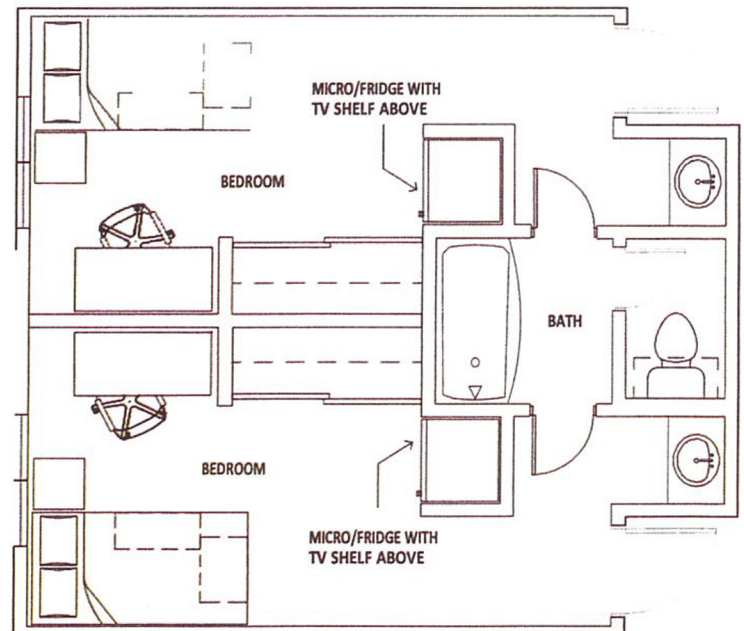

### 2 Bed - 1 Bath Livingroom

Private Bedroom, Shared Bathroom

\$3,870 Per semester

